

Breville®

Turn **on** your creativity®



 **BRITA**



Instant HotCup™ water dispenser
variable temperature and volume

PRODUCT SAFETY

READ CAREFULLY AND KEEP FOR FUTURE REFERENCE

This appliance can be used by children aged from 8 years and above and persons with reduced physical, sensory or mental capabilities or lack of experience and knowledge if they have been given supervision or instruction concerning use of the appliance in a safe way and understand the hazards involved. Children shall not play with the appliance. Cleaning and user maintenance shall not be made by children unless they are older than 8 and supervised. Keep the appliance and its cord out of the reach of children aged less than 8 years.

Never use a power base other than the one supplied with the appliance.

Never fill the water tank above the MAX marking. If the water tank is overfilled, boiling water may be ejected.

If the supply cord is damaged, it must be replaced by the manufacturer, its service agent or similarly qualified persons in order to avoid a hazard.

- ⚠ This appliance generates heat during use. Adequate precaution must be taken to prevent the risk of burns, scalds, fires or other damage to persons or property caused by touching the exterior whilst in use or during cooling.
- ⚠ Never use this appliance for anything other than its intended use. This appliance is for household use only. Do not use this appliance outdoors.
- ⚠ Always ensure that hands are dry before handling the plug or switching on the appliance.
- ⚠ Always use the appliance on a stable, secure, dry and level surface.
- ⚠ This appliance must not be placed on or near any potentially hot surfaces (such as a gas or electric hob).
- ⚠ Do not use the appliance if it has been dropped, if there are any visible signs of damage or if it is leaking.
- ⚠ Ensure the appliance is switched off and unplugged from the supply socket after use and before cleaning.
- ⚠ Always allow the appliance to cool before cleaning or storing.
- ⚠ Never immerse the main body, power base or power cord and plug in water or any other liquid.
- ⚠ Never let the power cord hang over the edge of a work top, touch hot surfaces or become knotted, trapped or pinched.
- ⚠ Never leave the appliance unattended when in use.
- ⚠ Never open the lid during the boiling cycle.
- ⚠ Never fill the appliance when it is connected to power.
- ⚠ Never use the appliance without sufficient water in it for it to operate correctly.
- ⚠ Never allow the appliance to boil dry.
- ⚠ Always operate the appliance with a cup or suitable container placed below the dispensing nozzle.
- ⚠ Only use the appliance to dispense water, not other liquid.

IDENTIFYING THE PARTS

1. Removable magnetic drip tray
2. Removable silicone drip tray cover
3. Dispensing nozzle
4. Control Panel
 - a. Control Dial with start/stop function and manual dispense)
 - b. Safety lock
 - c. Volume selection
 - d. Temperature selection
 - e. Temperature indication
5. Water tank lid
6. Removable water filter holder
7. Large removable water tank
8. BRITA water filter cartridge

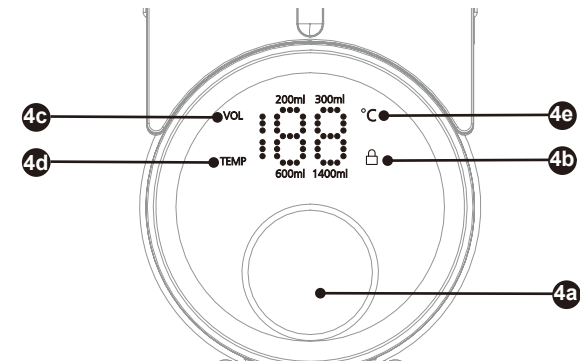
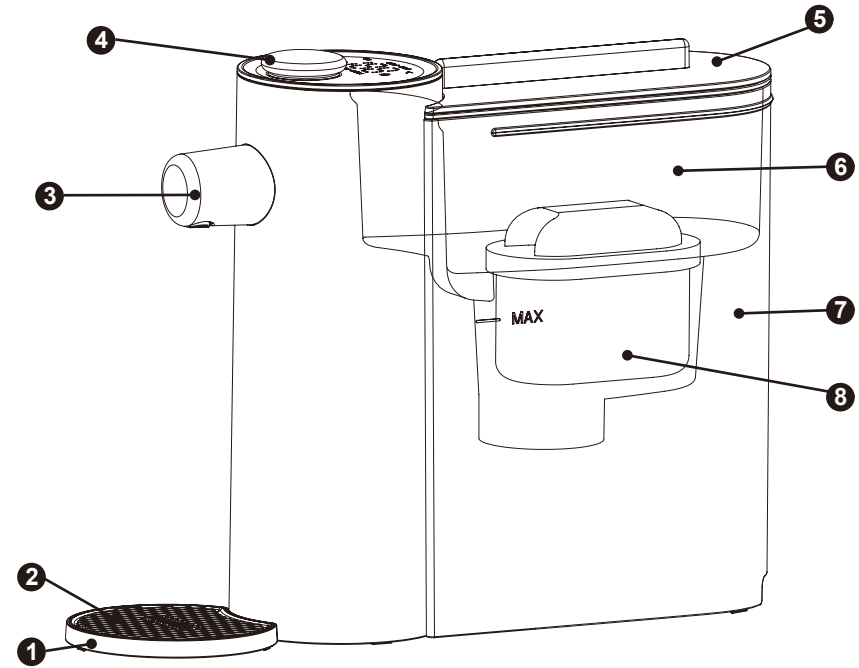

PREPARING THE BRITA® CARTRIDGE

1. Remove the cartridge from its wrapping (it is normal for the cartridge to appear moist during storage).
2. Immerse the cartridge in cold tap water and shake gently to remove any air bubbles. There is no need to pre-soak this cartridge before use.
3. Lift the complete lid off your HotCup™ water dispenser and remove the filter funnel. Insert the cartridge into the filter funnel and push it firmly into place. When correctly fitted, the cartridge should remain in place when the funnel is turned upside-down.
4. Fill the filter funnel with cold tap water up to the MAX mark and allow it to filter through discarding the water. Repeat this process, again discarding the water.
5. The BRITA® cartridge is now ready for use. You do not need to keep the filter cartridge immersed in water. Refit the filter funnel and filter into your HotCup™ water dispenser. Replace the lid.
6. Always make sure that you have spare cartridges to hand. When buying new cartridges look for the BRITA® logo on the cartridge packaging.
7. When it is time to replace the BRITA® filter cartridge after 4 weeks use, simply grip the top of the cartridge and pull upwards to remove. BRITA® cartridges are 100% recyclable. Visit www.brita.co.uk or call the BRITA® Care team on 0344 742 4800 for further information on participating retailers.
8. Repeat steps 1-5 with a new cartridge.

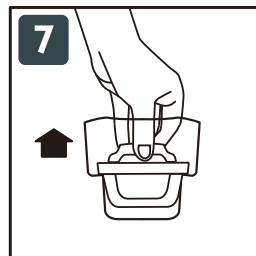
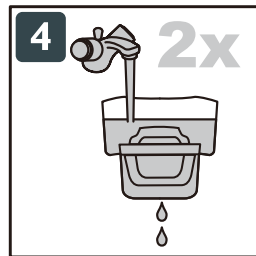
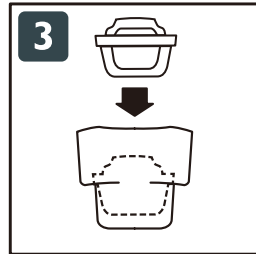
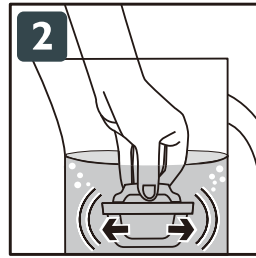

BEFORE USING YOUR INSTANT HOTCUP™ WATER DISPENSER FOR THE FIRST TIME

- Remove your HotCup™ water dispenser carefully from the box. Remove any packaging and promotional material and position your HotCup™ water dispenser on a dry, level, secure work surface away from the edge.
- Follow the instructions below and discard the first full tank of water. This will remove any residues that may remain from the manufacturing process.
- Fit the filter funnel and the BRITA® water filter—see pages 6.

USING YOUR INSTANT HOTCUP™ WATER DISPENSER

▲ Always position your HotCup™ water dispenser in such a way that the start button cannot be accidentally operated, especially by children. As you use your HotCup™ water dispenser, always use care when handling your HotCup™ water dispenser.

1. Lift the lid from the water tank and place on the counter top. You can either fill your tank via a jug or remove the water tank and take it to the water tap to fill.
2. Fill the filter funnel from your cold tap up to the raised ledge on the outside of the main water tank. Allow the water to filter through into the water tank. Repeat until the water level in the main tank is no higher than the MAX marking on the water tank.
3. Place the lid on the water tank. If you filled at the tap, replace the water tank onto the main body.
4. Connect your HotCup™ water dispenser to the mains supply socket and switch the machine on at the wall. You will hear an audible beep and the control panel will illuminate.
5. Place a suitable cup or container underneath the dispensing nozzle. With the variable temperature and dispense the Instant HotCup™ can be used for tea, coffee, hot chocolate, and any food items where hot or boiling water is required.

WARNING: Never operate your HotCup™ water dispenser without a cup or suitable container placed below the dispensing nozzle.

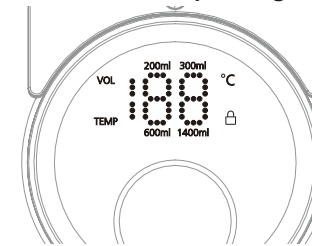

SETTING YOUR DISPENSE VOLUME

6. You can select one of the four pre-set volumes. Choose 200ml or 300ml for various teas and coffees, or 600ml and 1400ml for larger containers and meal prep needs. To adjust the dispensing volume touch the 'VOL' icon – this will illuminate 200ml – select your volume by rotating the control dial clockwise to scroll through 200ml, 300ml, 600ml or 1400ml. When you have selected the right volume touch the 'VOL' icon again to lock in your selection.



NOTE: If the 'VOL' icon is not selected, the machine will be locked after 60seconds of no operation.

SETTING YOUR TEMPERATURE

7. Touch the 'TEMP' icon – this will default to 25C – select your temperature by rotating the control dial clockwise to scroll through 25, 45, 55, 65, 75, 85 or 100C. When you have selected the right temperature touch the 'TEMP' icon to lock in your selection.

NOTE: If the 'TEMP' icon is not selected, the machine will be locked after 60 seconds of no operation.

BEGIN YOUR HOTCUP™ DISPENSE

8. To activate the Dispense press the control dial once. The water will dispense in a continuous flow of water – when it comes to the end of the volume dispense the unit will provide a series of countdown beeps. You can hear beep sound when turning the control dial for temperature and volume selection. To activate/de-activate the sound, touch and hold 'TEMP' and  for 3 seconds. If you delay selecting anything for more than 60 seconds the machine will enter 'Lock' mode. To re-activated touch the  for 3 seconds – as it will default to 200ml, 25C after unplug.

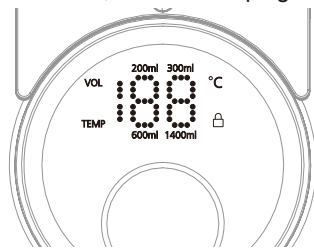

STOPPING YOUR HOTCUP™ WATER DISPENSER

If you have started the HotCup™ water dispense and then decide you want to stop your HotCup™ water dispense for any reason, simply press and hold the control dial. This may take a few seconds as the flow through heater will exit some water. You can also stop water that is being dispensed by pressing and holding the control dial.

CUSTOMISING YOUR INSTANT HOTCUP™ WATER DISPENSE VOLUME

You can customise your volume to suit your favourite cup or mug, choose any volume between 150ml – 1400ml.

How to customise your dispense

1. Ensure the control panel is 'unlocked' by touching the  for 3 seconds.
2. Select your chosen temperature ahead of customising your volume.
3. Touch the 'TEMP' icon – this will default to 25C – select your temperature by rotating the control dial clockwise to scroll through 25, 45, 55, 65, 75, 85 or 100C.
4. When you have selected the right temperature touch the 'TEMP' icon again to set.

Now customise your volume:

5. Ensure you have a vessel, cup or mug large enough for your customisable volume
6. Press and hold the 'VOL' icon for 3 seconds, the 'VOL' illumination will cease, swiftly 'double-click' the control dial to begin the dispense.
7. Once you have dispensed the volume you want press the control dial once to

cease the dispense. There will be a couple of seconds release before the unit stops dispensing.

8. Your customised volume is now memorized. To dispense the customised volume, press the control dial once. You can select different temperature in this function.
9. To De-activate and remove the customised setting press and hold 'VOL' for 3 seconds.

NOTE: During dispense only the temperature will display.

NOTE: If the unit is switched off at the power socket your memorised volume will default back to the main setting and will need to be reset.

LOW/NO WATER SIGNAL

When the unit is low on water during operation the unit will immediately cut off the power to the heater pipe and the water pump will pump for 15 seconds. If there is no water the buzzer will sound 5 times to end the operation and the unit display will read E0.

LOCKING/UNLOCKING THE INSTANT HOTCUP™

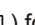
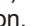
1. To un-lock the HotCup™ press and hold the child lock () for 3 seconds and the HotCup™ will unlock. After unlocking the HotCup™ will return to the temperature and water level before locking.
2. To lock the HotCup™, press and hold the child lock () for 3 seconds to lock the HotCup™. The () will remain the only illuminated icon.

CLEANING

▲ Always switch off and unplug your HotCup™ water dispenser and allow it to completely cool before cleaning. Never immerse the main body, power base, power cord or plug in water or any other liquid. Do not use harsh abrasives, chemicals or oven cleaners.

Emptying your HotCup™ water dispenser

1. Remove the large water tank and place on the counter.
2. Remove the water filter holder.
3. Take the large water tank to the sink and pour out the excess water.
4. Replace the water filter holder in to the water tank.
5. Replace the large water tank on the HotCup™ main housing.

Your HotCup™ water dispenser is now empty.

If your HotCup™ water dispenser will not be used for an extended period (e.g. if you are on holiday), we recommend that you first empty it.

Before using your HotCup™ water dispenser again, carry out several boil cycles discarding the water each time.

Cleaning

Clean the exterior surface of your HotCup™ water dispenser with a damp cloth and then polish it with a soft, dry cloth. Do not use steel wool pads or harsh/abrasive cleaners.

DESCALING

To maintain its performance, your HotCup™ water dispenser will require descaling once every three months or so. You may need to descale your HotCup™ water dispenser more frequently if you live in a hard water area.

By changing the MAXTRA+® cartridge more frequently, you will need to descale less often. BRITA® recommends to exchange the MAXTRA+® cartridge every 4 weeks.

1. Completely remove the lid and remove the filter funnel and filter. Fill your HotCup™ water dispenser to the MAX marking on the water chamber and place an empty cup on the drip tray. Replace the lid. Select a suitable setting for the dispensing control and press the start button. Wait for the water to be dispensed into the cup.
2. Add a citric acid-based proprietary descaling product to the hot water in the cup and stir.
3. Tip the contents of the cup into your HotCup™ water dispenser and close the lid.
4. Place the empty cup on the drip tray and press the start button.
5. Wait for the water to be dispensed into the cup.
6. Discard the water from the cup.
7. Repeat steps 4, 5 and 6 until your HotCup™ water dispenser is empty. Fill your HotCup™ water dispenser with fresh water to the MAX fill level and place an empty cup on the drip tray.
8. Press the start button and wait for the water to be dispensed into the cup.
9. Discard the water in the cup.
10. Repeat steps 8 and 9 until your HotCup™ water dispenser is empty. This will rinse any remaining descaling solution from your HotCup™ water dispenser.
11. When your HotCup™ water dispenser is completely cleaned, reinsert the filter funnel and filter. Your HotCup™ water dispenser is ready for use again.

TROUBLESHOOTING

Problem	Possible Cause	Solution
The Instant HotCup™ will not operate after the last dispense.	Your HotCup™ water dispenser has not reset itself after the boiling cycle.	Your HotCup™ water dispenser is still too hot after the last boil cycle. Wait a few seconds for it to cool slightly before trying again.
Your HotCup™ water dispenser does not dispense boiling water.	Your HotCup™ water dispenser is not plugged in. <ul style="list-style-type: none"> • Your water tank is not place in position. • Dispense has boiled dry (E1). 	<ul style="list-style-type: none"> • Check your HotCup™ water dispenser is plugged in and switched on at the supply socket. • Check that the dispensing nozzle is positioned centrally over the drip tray. • Check the fuse in the plug. • Allow your HotCup™ water dispenser to cool down completely then refill it with water.
Your HotCup™ water dispenser does not dispense a full cup of water.	<ul style="list-style-type: none"> • Your HotCup™ water dispenser has excessive scale. • The dispensing control may be set too low. 	<ul style="list-style-type: none"> • Descal your HotCup™ water dispenser. • Adjust the dispensing control.

CONNECTION TO THE MAINS SUPPLY

ELECTRICAL SAFETY Class I (earth)

This appliance must be earthed.

If the plug is not suitable for the socket outlets in your home, it can be removed and replaced by a plug of the correct type.

If the fuse in a moulded plug needs to be changed, the fuse cover must be refitted. The appliance must not be used without the fuse cover fitted.

If the plug fuse requires replacement, a fuse of the same rating as that fitted by the manufacturer must be used. In order to prevent a hazard do not fit a fuse of a lower or higher rating.

If the terminals in the plug are not marked or if you are unsure about the installation of the plug please contact a qualified electrician.

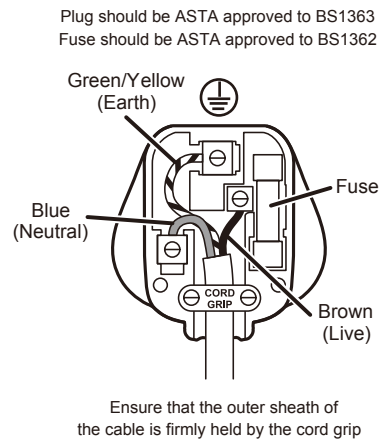

AFTER SALES SERVICE AND REPLACEMENT PARTS

In the case the appliance does not operate but is under warranty, return the product to the place it was purchased for a replacement. Please be aware that a valid form of proof of purchase will be required. For additional support, please contact our Consumer Service Department at **0800 028 7154** or email: **BrevilleEurope@newellco.com**.

WASTE DISPOSAL

Waste electrical products should not be disposed of with household waste. Please recycle where facilities exist. E-mail us at **BrevilleEurope@newellco.com** for further recycling and WEEE information.

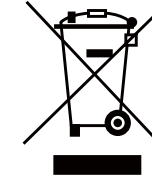

RECYCLING

The BRITA® cartridge is 100% recyclable. Look out for BRITA® recycling points in major retailers or visit www.brita.co.uk for more information.

NOTE

NOTE

Breville®

Newell Brands UK Limited.
5400 Lakeside, Cheadle Royal Business Park, Cheadle, SK8 3GQ, United Kingdom
Newell Poland Services Sp. z o.o.,
Plac Andersa 7, Poznan, 61-894, Poland.
e-mail: BrevilleEurope@newellco.com
Telephone: 0800 028 7154



©2023 Newell Brands UK Limited. All rights reserved.
Newell Brands UK Limited, 5400 Lakeside, Cheadle Royal Business Park,
Cheadle, Cheshire, SK8 3GQ, United Kingdom.
Newell Poland Services Sp. z o.o., Plac Andersa 7, Poznan, 61-894, Poland.
Newell Brands UK Limited and Newell Poland Services Sp. z o.o. are
subsidiaries of Newell Brands Inc.
The product you buy may differ slightly from the one shown on this carton due to continuing
product development.
Printed in China

